

"THIS MEDIA SHOULD NOT BE CONSIDERED A CERTIFIED DOCUMENT."

DATE PREPARED  
12/16/2011

ROUTE I-70 STATE MO  
DISTRICT SL SHEET NO.

COUNTY ST. LOUIS CITY  
JOB NO. J612377B  
CONTRACT ID.

PROJECT NO.

BRIDGE NO.

DESCRIPTION

DATE

MISSOURI HIGHWAYS AND TRANSPORTATION COMMISSION



105 WEST CAPITOL  
JEFFERSON CITY, MO 65102  
1-888-ASK-MODOT (1-888-275-6636)

PROFILES

SHEET 1 OF 2

IF A SEAL IS PRESENT ON THIS SHEET IT HAS BEEN ELECTRONICALLY SEALED AND DATED.

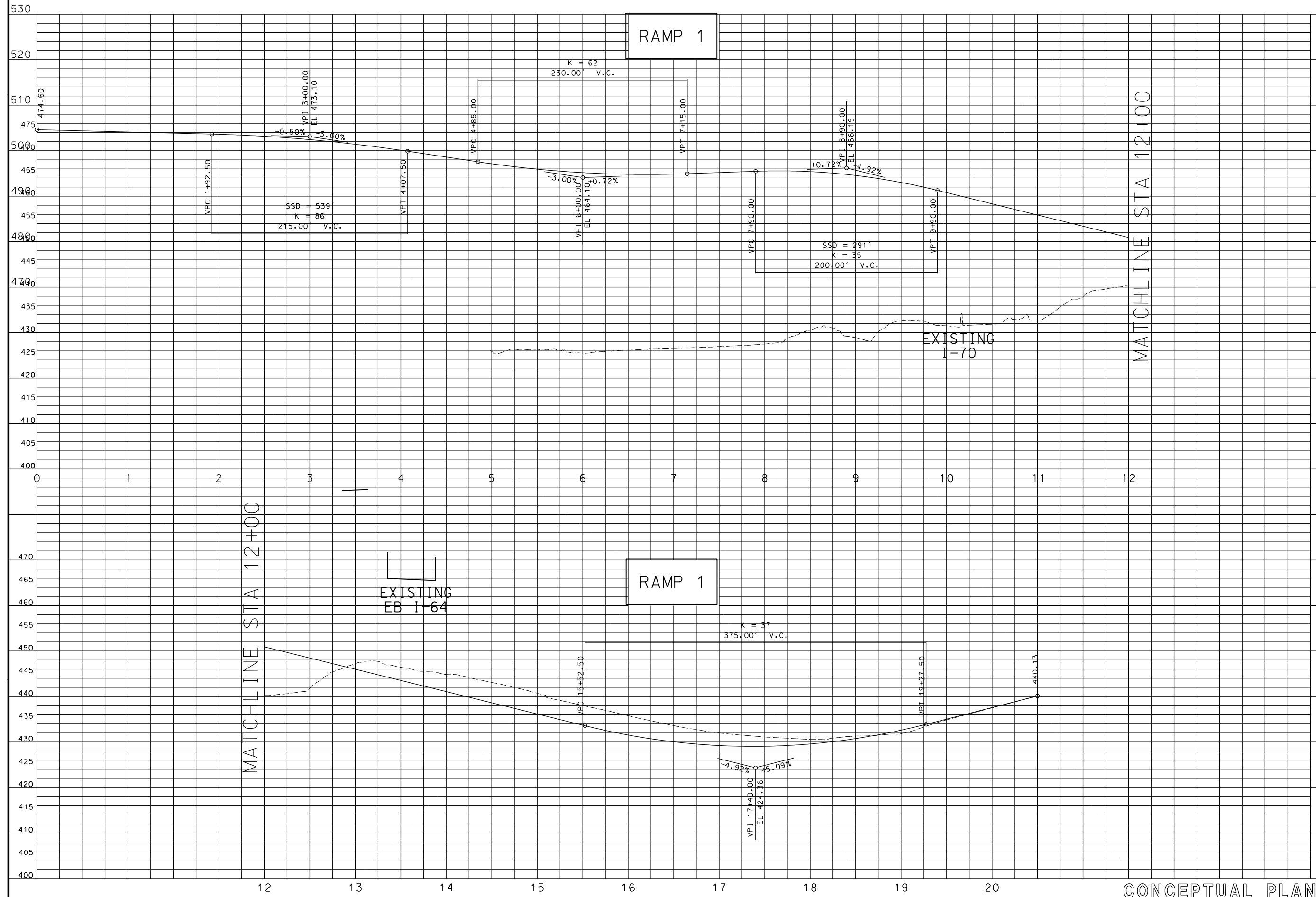

RAMP 1

RAMP 1

MATCHLINE STA 12+00

MATCHLINE STA 12+00

EXISTING  
EB I-64

EXISTING  
I-70

CONCEPTUAL PLANS

SSD = 539  
K = 86  
275.00' V.C.

K = 62  
230.00' V.C.

SSD = 291'  
K = 35  
200.00' V.C.

K = 37  
375.00' V.C.

530

520

510

500

490

480

470

460

455

450

445

440

435

430

425

420

415

410

405

400

400

0 1 2 3 4 5 6 7 8 9 10 11 12

12 13 14 15 16 17 18 19 20